

High Intensity Easy-Clean Liquid Filters



Liquid filters are designed to remove micron sized ferrous and paramagnetic contamination from various types of liquids.

A matrix of Easy-Clean rods containing high intensity Rare Earth Neodymium Iron Boron magnets are housed within a stainless steel vessel.

The magnetic configuration ensures maximum exposure of contamination to the high intensity rods without impeding liquid flow.

Filters are available in two versions, single wall and double wall jacketed. Jacketed filters are used in heated pipeline applications where temperature is critical to the product viscosity, for example, chocolate, syrups, jams and sauces.

Both versions are tested and certified to operate at pressures up to 6 bar as standard. The inlet and outlet pipes are supplied with a range of standard pipeline connections to suit your specification. For example, RJT, IDF, ANSI or BSP Threaded making them ideal for food applications.

The units are manufactured using 316 grade Stainless Steel and are supplied with securing band clamp.

Main features and benefits:

- High intensity flux fields emit from the pole concentrators generating 9,000 Gauss on the rod surface.
- Totally maintenance free (apart from cleaning), no power supply, no running costs.
- All contact parts are manufactured from 316 grade Stainless Steel.
- Inlet and outlet supplied in a range of connections.
- Incorporating the Easy-Clean facility, for quickly removing attracted contamination.
- Contamination assessment can be carried out.
- Quick & easy to install. Once in position, you know it is definitely working.
- Provides ultimate protection from a wide range of fine product contamination.
- Supplied with full test certificate.
- Guarantee on magnetic performance.

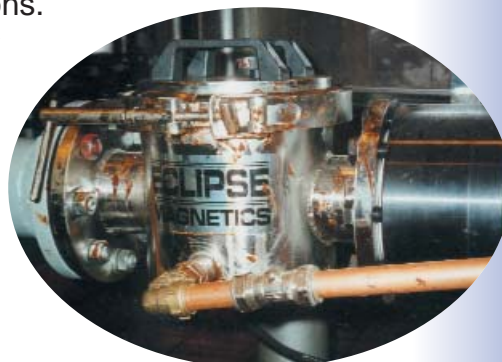

Technical Specifications

Eclipse Magnetics has a full range of magnetic separators to cover all applications. Many separators can be tailor made to exactly suit existing process pipeline and duct work.

Magnetic Performance: High strength 9,000 Gauss

Magnetic Material: High Energy 'Rare Earth' Neodymium Iron Boron

Material Specification: 316 grade Stainless Steel.

Finish: Polished.

Limitations: Standard Liquid Filters should not be exposed to temperatures in excess of 100 °C (212 °F). Special filters are available to operate at temperatures up to 350 °C (662 °F), for more information please contact our Technical Department for advice.

Single Wall

Part No.	Dia. A (mm)	Dia. B (mm)	C (mm)	D (mm)	No. of rods	Weight (kg)
ILF200/50	200	50	200	350	7	30
ILF200/75	200	75	200	350	7	30
ILF300/50	300	50	300	450	9	65
ILF300/75	300	75	300	450	9	65
ILF300/100	300	100	300	450	9	65

Double Wall - Jacketed

Part No.	Dia. A (mm)	Dia. B (mm)	C (mm)	D (mm)	No. of rods	Weight (kg)
ILF200/50/J	200	50	200	350	7	30
ILF200/75/J	200	75	200	350	7	30
ILF300/50/J	300	50	300	450	9	65
ILF300/75/J	300	75	300	450	9	65
ILF300/100/J	300	100	300	450	9	65

NB. When ordering please specify connection details.

Non-Standard Sizes Available - Fast!

Eclipse can design and manufacture liquid filters to exactly match existing pipework and fittings / couplings.



P.T.F.E. coated unit for an arduous chemical application



20 Bar unit for high pressure pipeline

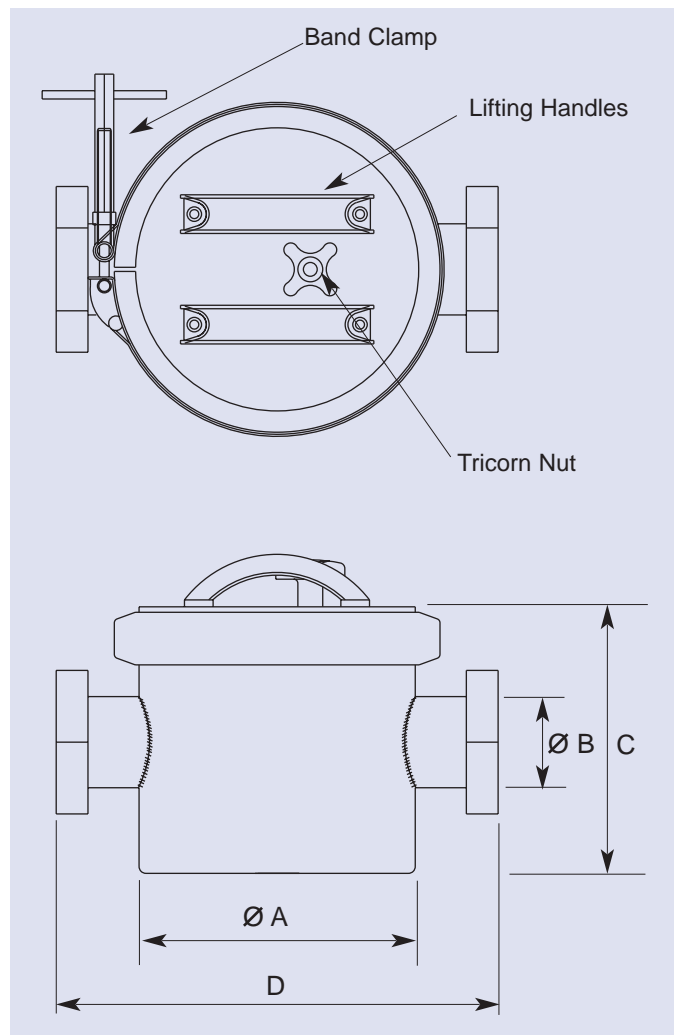

B - Nominal Bore Dimension

Simply supply details of your requirements for a fast no obligation quotation.



If it's Magnetic

....Then it's Eclipse Magnetics

Eclipse Magnetics Ltd - Separation Division
Units 1-4 Vulcan Road, Sheffield, S9 1EW, England

Tel: 0114 225 0500
Fax: 0114 225 0525

E-mail: sales@eclipse-magnetics.co.uk

Web Site: www.eclipse-magnetics.co.uk